





A SYSTEM WITH NUMEROUS ADVANTAGES

- » **AESTHETICS:** harmonious integration into the roof
- » **PERFORMANCE:** optimum yields due to special construction with ample ventilation behind modules
- » **FLEXIBILITY:** suitable for all tiled or slate roofs with pitches between 15° and 60°
- » **SIMPLICITY:** quick installation thanks to cleverly designed system elements
- » **SAFETY:** rain-proof and weather-resistant due to drainage sheets
- » **QUALITY:** SolarWorld know-how and TÜV-certified system for highest safety



- Qualified PV Mounting System
- Periodic inspection

“Powerful” design for your roof

The perfect meeting of aesthetics and efficiency: with the SolarWorld high-performance solar modules mounted flush with the rest of the roof, the in-roof Sundeck solution gives a particularly tidy, designed-in look. Suitable for tiled roofs and slate roofs alike, it also sets new standards in appearance as a complete roof solution. Suitable for use with either our poly or black modules for very elegant results, particularly when matched with a building's black slates, tiles or materials necessary for sensitive or heritage projects.

Technically, the Sundeck impresses with its small number of perfectly integrated system elements. The cleverly-designed weather-tight substructure is attached directly to the roof battens, making it easier to install solar power systems than ever before.

At an average system weight of only around 22 kg/m², including the modules, Sundeck is between half and a third of the weight of the tiles or slates that it replaces. So, there's the additional double advantage of reduced loadings on the roof timbers plus the offset of the cost of needing considerably fewer tiles or slates to finish off your roof – a definite win/win in every situation.

Fulfilling all your expectations of a SolarWorld solar powersystem, the Sundeck kit is custom-prepared to meet the individual requirements of every installation. With the help of our SolarWorld construction experts and engineers, we develop the optimum tailor-made solution for each individual roof, guaranteeing maximum yields for decades to come. With a real designer piece on your roof and maximum yields, you will be reaping double benefits.

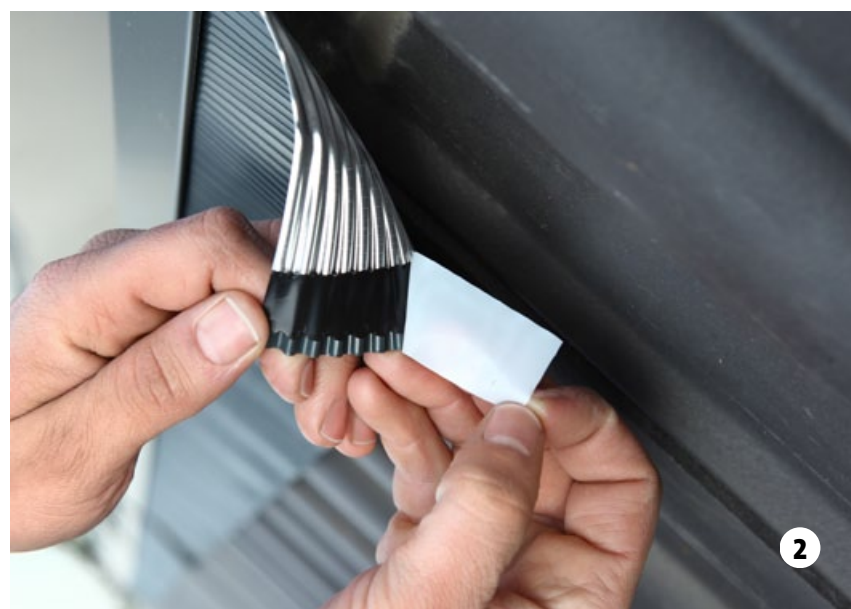
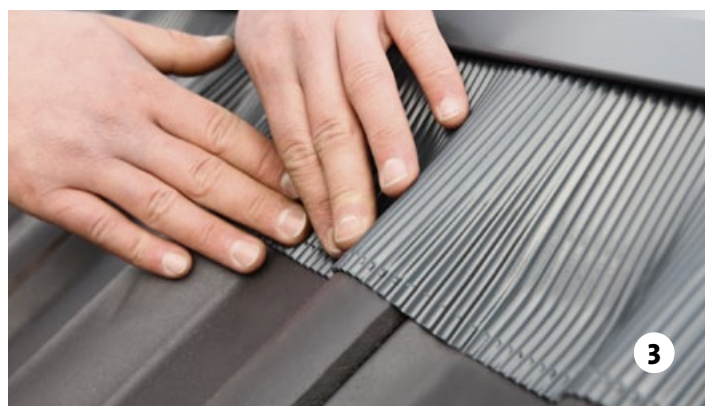
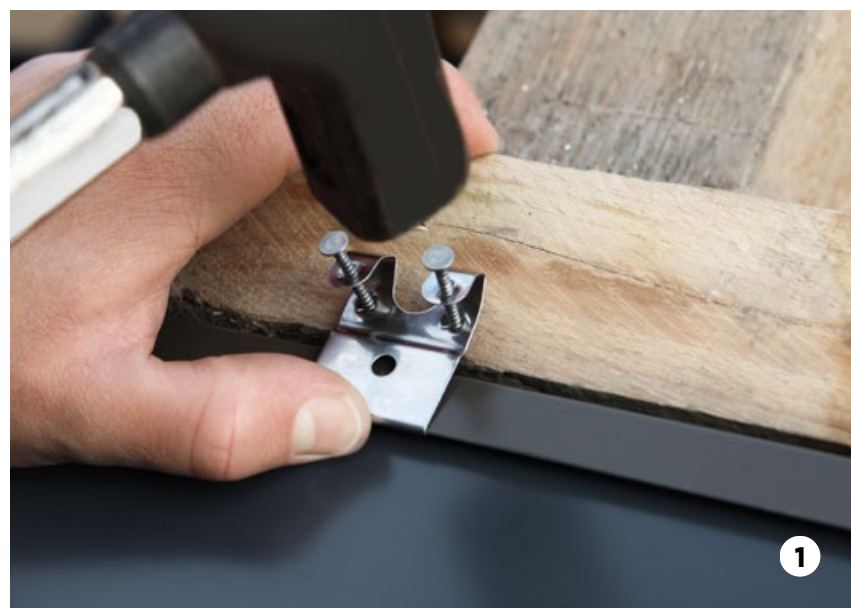

Installing your Sundeck in just a few steps

1 INSTALLING THE LOWER FLASHINGS

Following the alignment and setting-out process, the plates are fastened with pre-assembled clips.

2 3 ADJUSTING THE LOWER FLASHINGS

Using the aluminium skirt, the flashings are moulded onto the tiles and fixed into place with self-adhesive strip sections.

4 INSTALLING THE DRAINAGE SHEETS

The drainage sheets are interconnected in a modular fashion. They form both a strong weatherproof covering and the mounting framework for the modules. The specially-designed overlapping areas ensure reliable rainwater drainage and facilitate installation of the solar modules later due to the pre-defined grid spacing.

5 FITTING THE EQUIPOTENTIAL BONDING SCREW

The screw is fitted once per row, connecting the drainage sheets horizontally.



6 ATTACHING THE DRAINAGE SHEETS

Self-tapping screws ensure quick installation; no pre-drilling required. Higher waterproofing safety level through special sealing storm washers and sealing discs.

7 INSERTING THE LOWER MODULE CLAMP

The clamp is inserted using pre-assembled components with an integrated slot nut that is locked into position in a simple 90°-rotation. The long slot guarantees maximum flexibility, even on roofs with slight imperfections. Overlapping sheets repel rain and provide drainage channels.

8 9 FASTENING THE MODULES

The modules are attached to the drainage sheets with the help of clamping screws. Alignment is achieved with integrated pointers, yielding optimal results. The pantiles are connected to the generator array via lateral connection plates.

10 FINISHED SUNDECK SOLAR POWER SYSTEM

When combined with Sunmodule Plus mono black modules, a particularly harmonious combination of solar power system and roof covering can be achieved.

- 1 Existing roof insulation
- 2 Existing roof battens
- 3 Existing rooftop covers
- 4 Existing sarking membrane or underfelt
- 5 Sundeck flashings
- 6 Sundeck drainage sheets
- 7 Sundeck support profile
(only for Sundeck 8500 version)
- 8 Sunmodule Plus solar modules

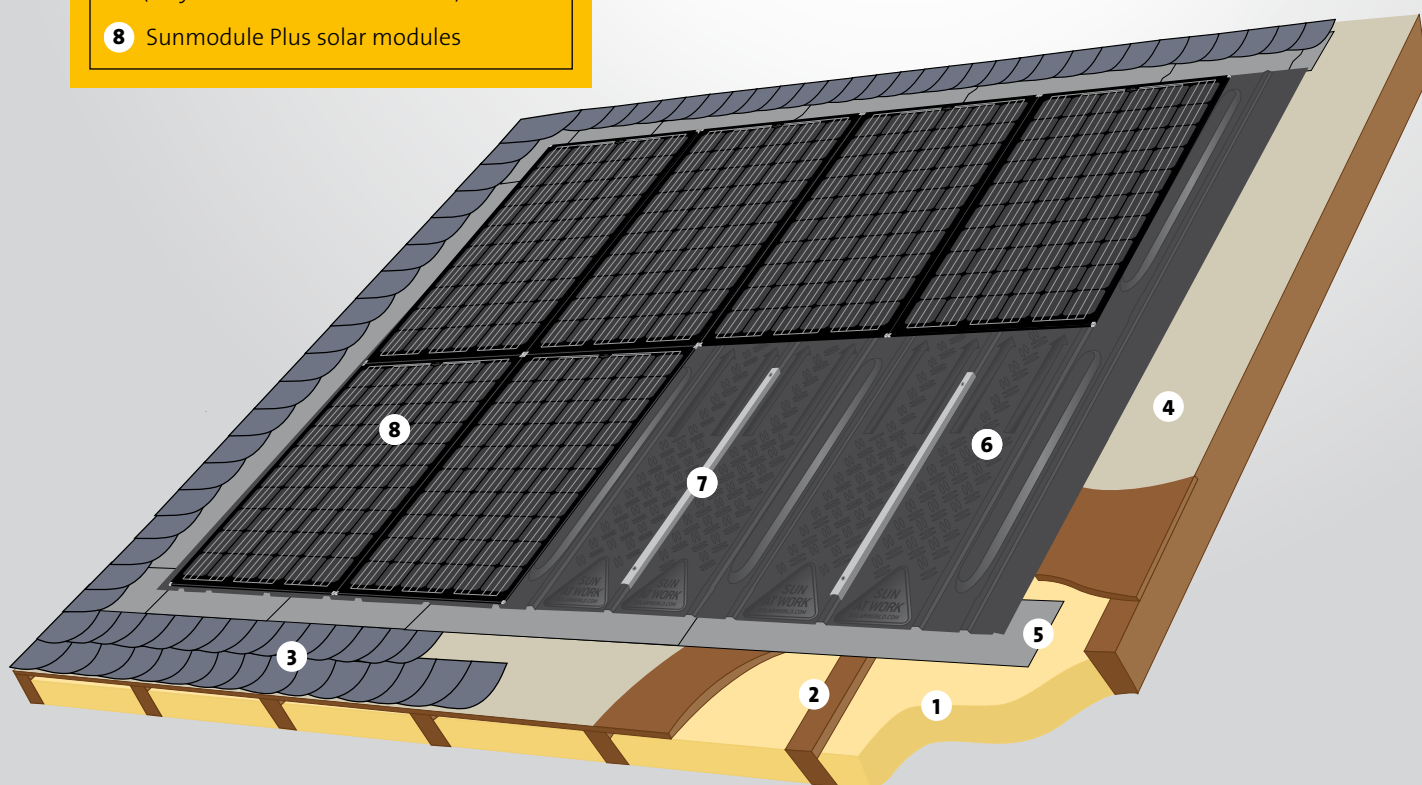

Sundeck: the all-around kit

Whether a new build, a re-roof or roof restoration – the Sundeck can be easily integrated into any tiled or slate roof with an incline between 15° and 60°.

The low number of pre-assembled components making up the Sundeck kit is proof of its technical maturity: all you need for quick installation is our Sunmodule Plus solar modules, our Sundeck roof covering and installation system, an inverter, cables and the necessary tools. The drainage sheets serve as a rain-proof substitute for conventional roof covering and are attached to the existing roof substructure without the laborious application of aluminium profiles and roof hooks. Optional side, eaves and ridge flashings are available to facilitate the

connection between the solar power system and the roof covering for the numerous types and brands of tile and slate roofs.

>> Suitable for high loads: *the Sundeck 8500*

The Sundeck 8500 is built to withstand large amounts of snow: owing to its specially developed support profiles, it is suitable for combined loads of up to 8.5 kN/m² and allows for the generation of solar electricity in regions with extreme climate conditions.



SOLARWORLD PRODUCTS – LONGEVITY AND ADDED VALUE FOR YOUR ROOF

- » **GERMAN QUALITY STANDARDS:** Fully-automated production lines and seamless monitoring of the process and material ensure the quality that the company sets as its benchmark for its sites worldwide.
 - » **TUV “POWER CONTROLLED”:** With the new TUV Rheinland test “Power controlled” it is guaranteed that the performance indicated for a Sunmodule Plus solar modules is being met and that it is regularly monitored by the independent test service provider, TUV Rheinland. This additional security for investors and consumers is a further testament of SolarWorld’s commitment to comprehensive quality assurance.
 - » **AMMONIA RESISTANCE:** The DLG Fokus test has confirmed that our Sunmodule Plus products withstand high ammonia air environments and are suitable for agricultural and other sensitive applications. In addition, TUV Rheinland has issued a certificate confirming that the use of SolarWorld modules in ammoniacal air is safe and harmless.
 - » **25-YEAR LINEAR PERFORMANCE GUARANTEE AND 10-YEAR EXPANDED PRODUCT WORKMANSHIP WARRANTY*:** SolarWorld guarantees a maximum degeneration in performance of 0.7% p.a. for more than 25 years – a clear additional benefit compared with the conventional two-stage industry guarantees. In addition there is a product workmanship warranty that covers 10 years.
 - » **SUNKITS INSURANCE:** In cooperation with ERGO Insurance Group, we offer a comprehensive and free insurance package for Sunkits that covers, among other risks, fire, storms, over-voltage and interruption.
 - » **SOLARWORLD PLUS-SORTING:** Plus-sorting guarantees the highest system efficiency. Only modules that achieve the designated nominal performance or greater in performance tests are dispatched.
- * according to the SolarWorld service certificate valid at the time of purchase
www.solarworld-uk.co.uk/service-certificate



SolarWorld AG
 Martin-Luther-King-Str. 24
 53175 Bonn
 Germany
 Phone: +49 228 55920 0
 Fax: +49 228 55920 99
service@solarworld-uk.co.uk

www.solarworld-uk.co.uk



We turn sunlight into power.