

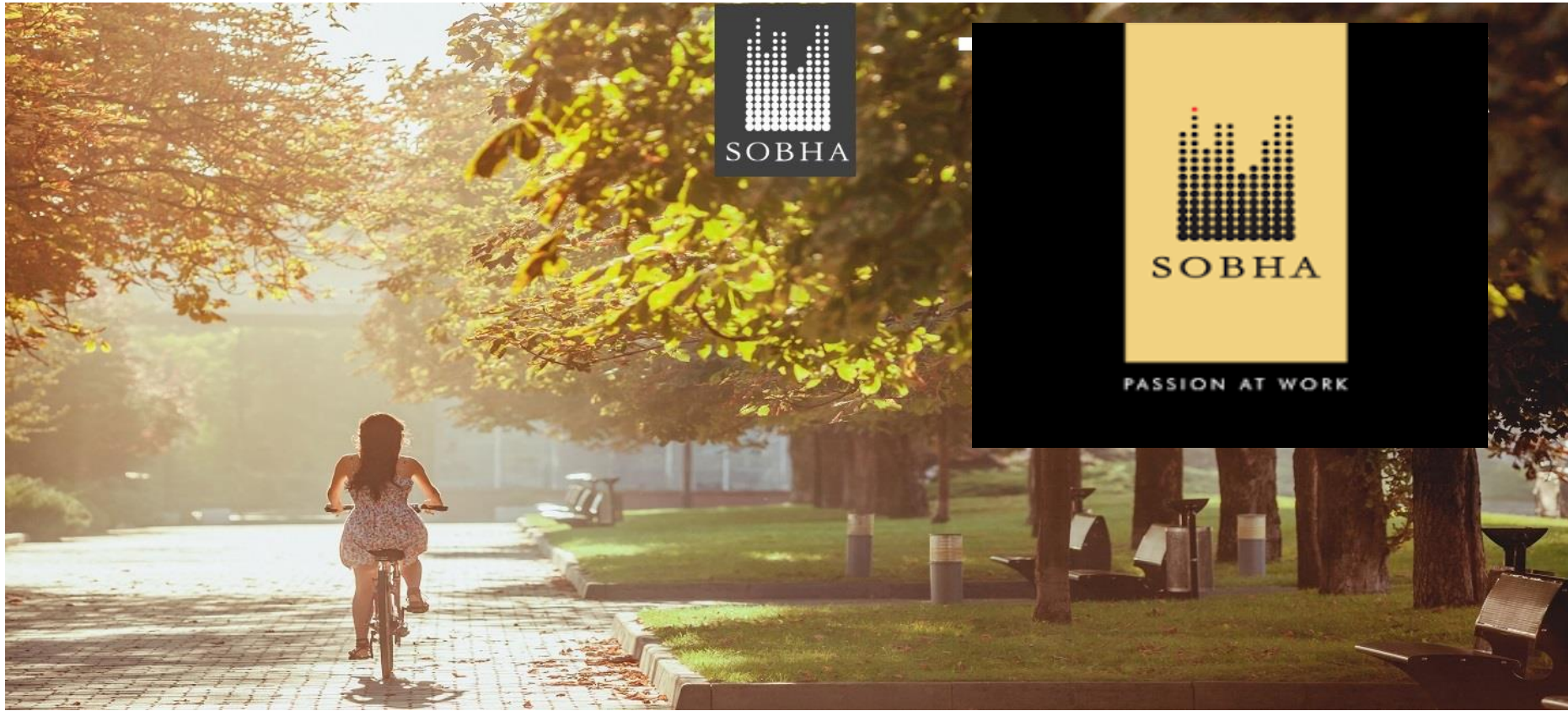

PASSION AT WORK

Sobha Sentosa

Panathur Road- East Bangalore



Sobha Limited - 2021 Launch High Rise Apartments in Bangalore

A modern, multi-story building with a light-colored facade and large windows, illuminated at night. The building is surrounded by landscaping, including palm trees and other plants. In the foreground, there is a swimming pool with a tiled deck. The sky is dark with some clouds.

Sobha Sentosa

About Builder

SOBHA Limited was founded in 1995 by Mr. P.N.C. Menon. Since inception, as of New Year's Eve , 2018, SOBHA has delivered land projects and contractual projects covering about 100.31 million square feet of area. the corporate currently has ongoing land projects aggregating to 39.09 million square feet of developable area and 27.23 million square feet of saleable area, and ongoing contractual projects aggregating to eight .89 million square feet under various stages of construction. the corporate features a land presence in 9 cities, viz. Bangalore, Gurgaon, Chennai, Pune, Coimbatore, Thrissur, Calicut, Cochin and Mysore. Overall, SOBHA has footprint in 26 cities and 13 states across India.



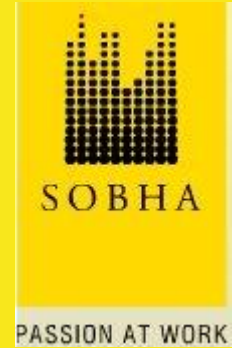

Overview of Sobha Townpark

Sobha Limited' new residential launch, The [Sobha Sentosa](#) is coming up on elegant locations of Hosur Road Electronic City, South Bangalore. This development showcases 2 and 3 BHK deluxe residential units which are roomy, airy and well-designed. The recreational outdoors are cautiously designed to involve each resident and to create an arena where they can happily spend their leisure hours.

Sobha Sentosa Location

it's within the Electronic City. one among the prime reasons people want to remain within the Electronic City or the E-City of Bangalore is for its connectivity. aside from housing a number of the enormous MNCs it's land buildings also . This place has the simplest schools, so you are doing not got to worry about your child's admission. Now coming to safety and security be very sure that this is often one among the safest places to remain during this city. During the odd hours of the day, you'll find girls returning from their offices. If you stay here you'll be never late to figure and you'll save time.

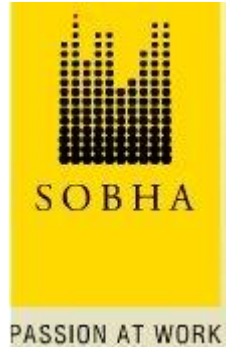

Sobha Apartments

[Sobha Sentosa Floor Plan](#)

[Sobha Sentosa Price](#)

[Sobha Sentosa Amenities](#)

[Sobha Sentosa Specification](#)

[Sobha Sentosa Gallery](#)

[Sobha Sentosa Contact](#)



PHOTOGRAPH - Indicative in nature and is for general information purpose only.

An aerial photograph of a modern commercial and residential complex in Bangalore. The complex features a tall, slender tower and a large, multi-story building with a distinctive facade of white and grey geometric panels. The building is surrounded by greenery and a road with a few vehicles. In the background, a dense urban landscape is visible under a clear blue sky. A yellow rectangular box is overlaid on the image, containing the text "Panathur Road Bangalore".

Panathur Road Bangalore

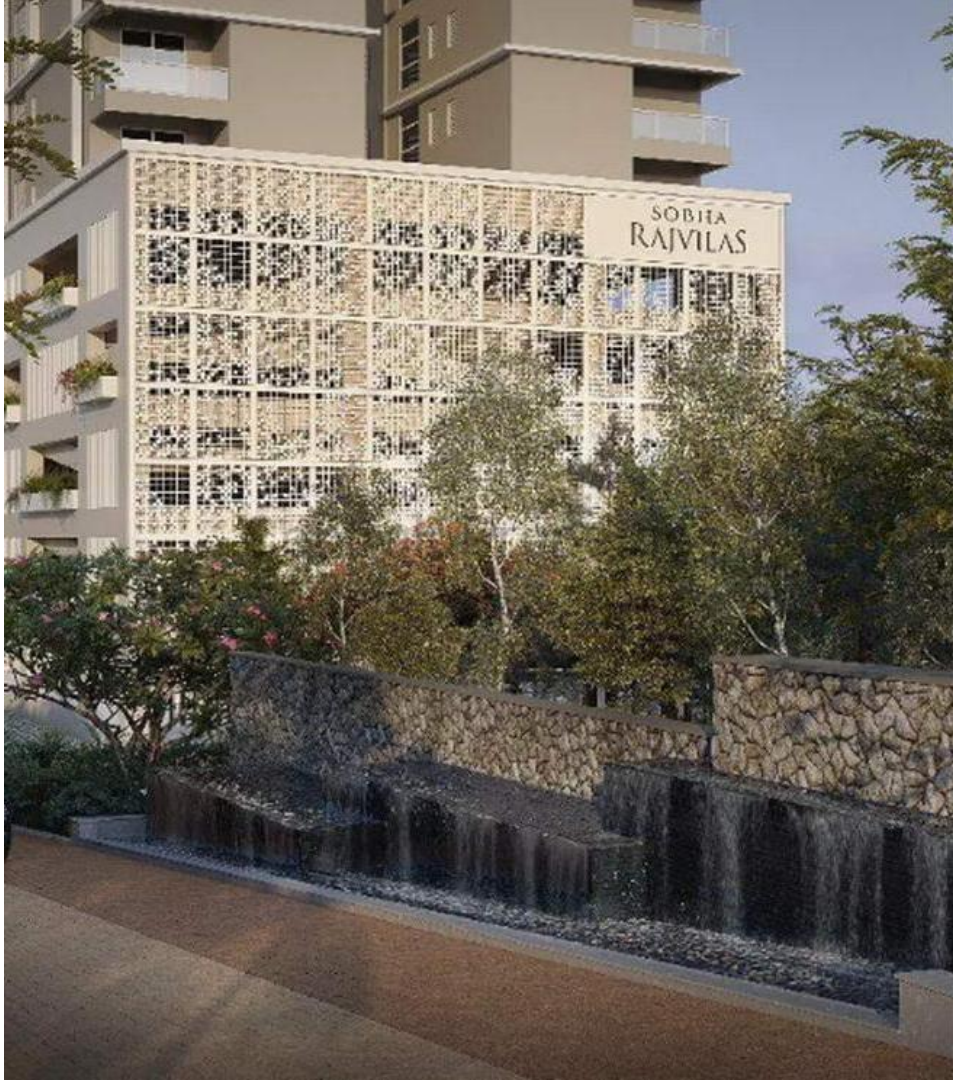



For Booking and More Information

Visit our

Website : www.sobhasentosa.org.in